

SUBMITTAL DATA: MSZ-FE12NA-8 & MUZ-FE12NA1
12,000 BTU/H WALL-MOUNTED HEAT PUMP SYSTEM

Job Name:

System Reference:

Date:

GENERAL FEATURES

- Highly energy-efficient system that features 92% heating capacity at 5°F, 75% at -4°F, and 58% at -13°F
- Updated sleek, compact indoor unit design
- Includes Standard, Platinum Deodorizing, and Anti-allergy Enzyme filters for a complete air purifying system
- “Powerful Mode” function permits system to temporarily run at a lower/higher temperature with an increased fan speed, which quickly brings the room to the optimum comfort level
- Integrated i-see Sensor automatically adjusts the unit’s operation according to temperature differences detected between the floor and the intake air, ensuring optimum comfort and energy usage
- Hand-held Wireless Remote Controller
- Base heater is available as an option
- Limited warranty: five years parts and seven years compressors

ACCESSORIES
Outdoor Unit

- Base Heater (MAC-640BH-U)
- Drain Socket (MAC-851DS)

Indoor Unit

- Condensate Pump (SI3100-230; 230V)
- Replacement Platinum Deodorizing Filter (MAC-308FT)
- Replacement Anti-allergy Enzyme Filter (MAC-418FT; MERV 8)

Controller Options

- Wireless Wall-mounted Remote Controller Kit (MHK1)*
- Portable Central Controller (MCCH1)*
- Outdoor Air Sensor (MOS1)*
- Wired Wall-mounted Controller (PAR-31MAA requires MAC-333IF)*
- Simple MA Remote Controller (PAC-YT53CRAU requires MAC-333IF)*

*See Submittal for information on each option.

- System Control Interface (MAC-333IF)
- Remote Temperature Sensor (M21-JKO-307)
- Lockdown Bracket for Hand-held Controller (RCMKP1CB)



SPECIFICATIONS: MSZ-FE12NA-8 & MUZ-FE12NA1

Cooling*

Rated Capacity 12,000 Btu/h
 Minimum Capacity 2,800 Btu/h
 SEER 23.0 Btu/h/W
 Total Input930 W

Heating at 47° F*

Rated Capacity 13,600 Btu/h
 Minimum Capacity 3,000 Btu/h
 HSPF 10.6 Btu/h/W
 Total Input950 W

Heating at 17° F*

Rated Capacity 7,900 Btu/h
 Rated Total Input750 W
 Maximum Capacity** 13,600 Btu/h
 Maximum Total Input 1,780 W

Heating at 5° F

Maximum Capacity** 12,512 Btu/h

*** Rating Conditions per AHRI Standard**

Cooling | Indoor: 80° F (27° C) DB / 67° F (19° C) WB
 Cooling | Outdoor: 95° F (35° C) DB / 75° F (24° C) WB
 Heating at 47° F | Indoor: 70° F (21° C) DB / 60° F (16° C) WB
 Heating at 47° F | Outdoor: 47° F (8° C) DB / 43° F (6° C) WB
 Heating at 17° F | Indoor: 70° F (21° C) DB / 60° F (16° C) WB
 Heating at 17° F | Outdoor: 17° F (-8° C) DB / 15° F (-9° C) WB
 Heating at 5° F | Indoor: 70° F (21° C) DB / 60° F (16° C) WB
 Heating at 5° F | Outdoor: 5° F (-15° C) DB / 5° F (-15° C) WB

**Maximum Capacity is at full speed and performance for INVERTER-driven System.

Electrical Requirements

Power Supply 208 / 230V, 1-Phase, 60 Hz
 Breaker Size 15 A

Voltage

Indoor - Outdoor S1-S2 AC 208 / 230V
 Indoor - Outdoor S2-S3 DC +/- 24V
 Indoor - Remote Controller MHK1 DC 3V
 PAR-31MAA DC 12V
 PAC-YT53CRAU DC 12V

OPERATING RANGE

		Indoor Intake Air Temp.	Outdoor Intake Air Temp.
Cooling	Maximum	90° F (32° C) DB 73° F (23° C) WB	115° F (46° C) DB
	Minimum	67° F (19° C) DB 57° F (14° C) WB	14° F (-10° C) DB
Heating	Maximum	80° F (27° C) DB 67° F (19° C) WB	75° F (24° C) DB, 65° F (18° C) WB
	Minimum	70° F (21° C) DB 60° F (16° C) WB	-13° F (-25° C) DB, -15° F (-26° C) WB**

** System cuts out at -18°F (-28°C) to avoid thermistor error, but recovers from cutout operation and automatically restarts at -13° F (-25° C).

Indoor Unit

MCA 1 A
 Blower Motor (ECM) 0.76 F.L.A.
 Airflow
 Cooling (Lo - Med - Hi - Powerful) 162 - 226 - 381 - 410 Dry CFM
 144 - 202 - 350 - 367 Wet CFM
 Heating (Lo - Med - Hi - Powerful) 166 - 240 - 399 - 420 Dry CFM
 Sound Pressure Level
 Cooling (Lo - Med - Hi - Powerful) 22 - 33 - 43 - 45 dB(A)
 Heating (Lo - Med - Hi - Powerful) 22 - 33 - 43 - 44 dB(A)

DIMENSIONS	UNIT INCHES / MM
W	31-7/16 / 799
D	10-1/8 / 257
H	11-5/8 / 295

Weight27 lbs. / 12 kg
 External Finish Munsell No. 1.0Y 9.2 / 0.2
 Field Drainpipe Size O.D. 5/8" / 15.88 mm
 Remote Controller Wireless

Outdoor Unit

Compressor DC Inverter-driven Twin Rotary
 MCA 12 A
 Fan Motor (ECM) 0.56 F.L.A.
 Sound Pressure Level
 Cooling 48 dB(A)
 Heating 49 dB(A)

DIMENSIONS	INCHES / MM
W	31-1/2 / 800
D	11-1/4 / 286
H	21-5/8 / 549

Weight80 lbs. / 36 kg
 External Finish Munsell No. 3.0Y 7.8 / 1.1
 Refrigerant Type R410A
 Refrigerant Pipe Size O.D.
 Gas Side 3/8" / 9.52 mm
 Liquid Side 1/4" / 6.35 mm
 Max. Refrigerant Pipe Length 65' / 20 m
 Max. Refrigerant Pipe Height Difference 40' / 12 m
 Connection Method Flared

Notes:

DIMENSIONS: MSZ-FE12NA-8 & MUZ-FE12NA1

MSZ-FE12NA-8

Unit: inch

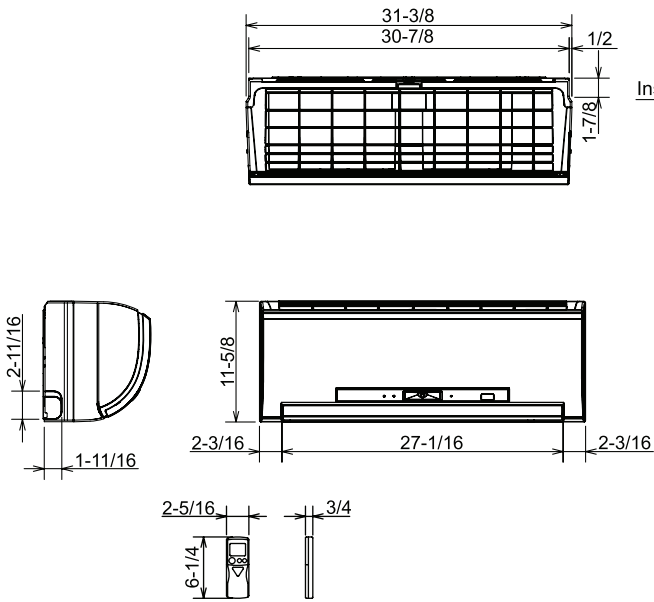

Piping	Insulation	ø1-3/8 O.D
	Liquid line	ø1/4 19-11/16 (Flared connection ø1/4)
	Gas line	ø3/8 16-15/16 (Flared connection ø3/8)
	Drain hose	Insulation ø1-1/8 O.D Connected part ø5/8 O.D

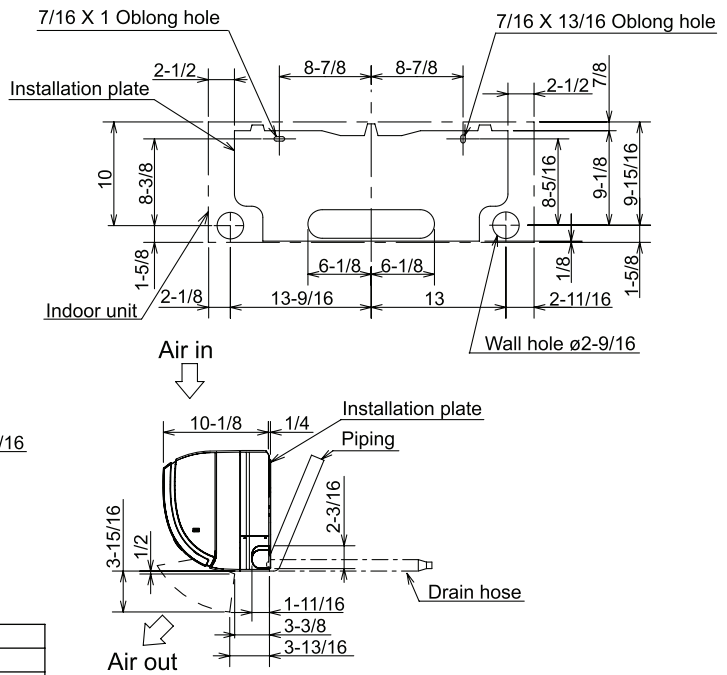

MUZ-FE12NA1

Unit: inch

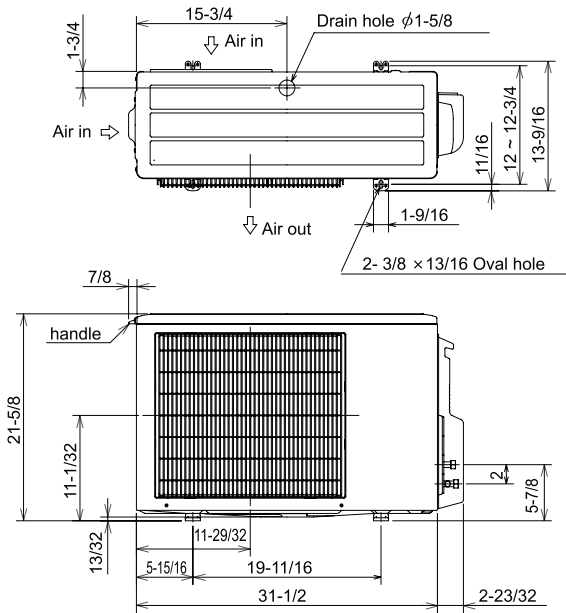

REQUIRED SPACE

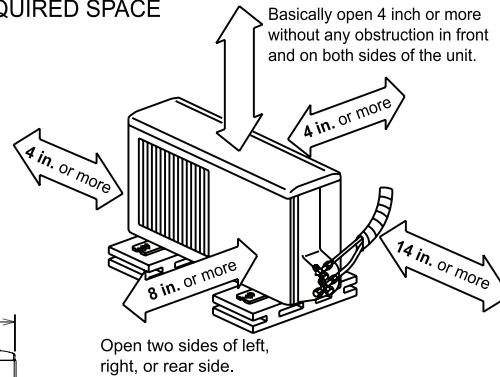

COOLING & HEATING

1340 Satellite Boulevard, Suwanee, GA 30024
Toll Free: 800-433-4822 www.mehvac.com

